



A Watch You Can Trust

**INSTRUCTION MANUAL FOR
WATCH CALIBRE
YM92**



WARNING



THIS PRODUCT CONTAINS A BUTTON BATTERY

If swallowed or placed inside any part of the body, the battery can cause severe or fatal injuries within 2 hours or less.

Button batteries are hazardous whether new or used. Keep batteries out of reach of children.

If you think the battery may have been swallowed or placed inside any part of the body, seek immediate medical attention. Contact the Australian Poisons Information Centre immediately on 13 11 26 (New Zealand 0800 764 766) for 24 / 7 fast, expert advice.

Instruction Manual

LORUS

CAL. YM92,7T92 (RF8 SERIES)

LORUS

■ CHARACTERISTICS

1. Time: Indicated by the hour, minute and small second hands.

2. Date: Displayed in numerals.

3. Stopwatch: Measures up to 12 hours in 1/20 second increments.

- Split time measurement

■ DISPLAY AND CROWN OPERATION

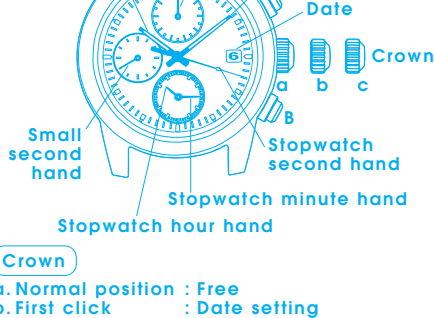

Crown

- a. Normal position : Free
 b. First click : Date setting
 c. Second click : • Time setting
 • Adjusting the stopwatch hand position

■ SETTING THE TIME AND ADJUSTING THE STOPWATCH HAND POSITION

- This watch is so designed that
 1) time setting and
 2) stopwatch hand position adjustment
 are both made with the crown at the second click position. Once the crown is pulled out to the second click, be sure to make the above adjustments at the same time.

1) Time setting

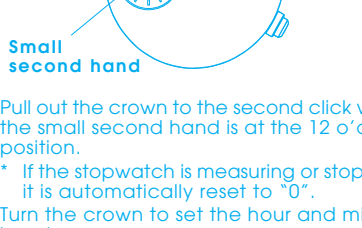

1. Pull out the crown to the second click when the small second hand is at the 12 o'clock position.
 * If the stopwatch is measuring or stopped, it is automatically reset to "0".
2. Turn the crown to set the hour and minute hands.
 * It is recommended that the hands be set to the time a few minutes ahead of the current time, taking into consideration the time required to adjust the stopwatch hand position if necessary.

Notes:

1. When setting the hour hand, be sure to check that AM/PM is correctly set. The watch is so designed that the date changes once in 24 hours.
2. When setting the minute hand, first advance it 4 to 5 minutes ahead of the desired time and then turn it back to the exact minute.

2) Stopwatch hand position adjustment

- If the stopwatch hands are not in the "0" position, follow the procedure below to set them to the "0" position.

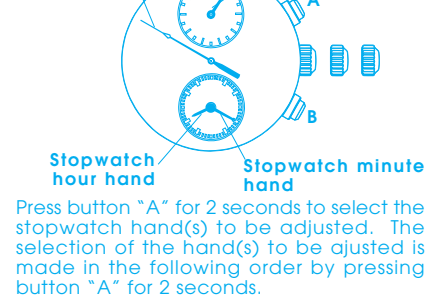

1. Press button "A" for 2 seconds to select the stopwatch hand(s) to be adjusted. The selection of the hand(s) to be adjusted is made in the following order by pressing button "A" for 2 seconds.



- * The selected hand(s) turn(s) a full circle.
2. Press button "B" repeatedly to set the selected stopwatch hand(s) to the "0" position.
 * The hand moves quickly if button "B" is kept pressed.
3. After all the adjustments are completed, push the crown back in to the normal position in accordance with a time signal, checking that the hour and minute hands for time display indicate the current time.

■ SETTING THE DATE

- Before setting the date, be sure to set the time.
- It is necessary to adjust the date at the end of February and 30-day months.

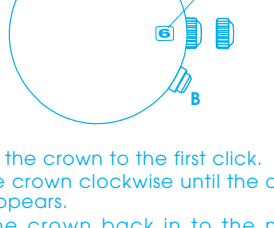

1. Pull out the crown to the first click.
2. Turn the crown clockwise until the desired date appears.
3. Push the crown back in to the normal position.

Note: Do not set the date between 9:00 p.m. and 1:00 a.m. Otherwise, the date may not change properly.

■ STOPWATCH

- The stopwatch can measure up to 12 hours in 1/20 second increments.
- The measured time is indicated by the four stopwatch hands that move independently of the hands for time display.
- When the measurement reaches 12 hours, the stopwatch automatically stops counting.

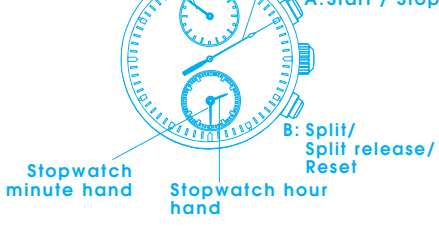

(Ex.: 2 hours, 30 minutes and 10.85 seconds)

Movement of the stopwatch 1/20-second hand

- After the stopwatch is started, the stopwatch 1/20-second hand moves for about 10 minutes and automatically stops at the "0" position.
- When the measurement is stopped or split time is measured, it moves to indicate the elapsed 1/20 seconds.
- After the measurement is restarted or split time is released, the stopwatch 1/20-second hand moves for about 10 minutes and stops automatically.
- In the same manner, if the stopwatch is stopped and restarted repeatedly or split time is measured and released repeatedly, the stopwatch 1/20-second hand moves for about 10 minutes and stops automatically.

☆ Before using the stopwatch, be sure to check that the crown is set at the normal position and that the stopwatch hands are reset to the "0" position.

* If the hands do not return to the "0" position, follow the procedure in "■ SETTING THE TIME AND ADJUSTING THE STOPWATCH HAND POSITION".

Stopwatch operation

Standard measurement



Accumulated elapsed time measurement



* Restart and stop of stopwatch can be repeated by pressing button "A".

Split time measurement

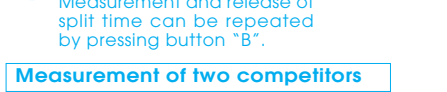

* Measurement and release of split time can be repeated by pressing button "B".

Measurement of two competitors

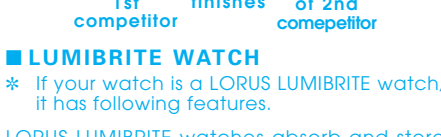

■ LUMIBRITE WATCH

* If your watch is a LORUS LUMIBRITE watch, it has following features.

LORUS LUMIBRITE watches absorb and store light energy from natural and artificial light sources and emit light in the dark. They are made of environmentally friendly material, and therefore, are harmless to human beings and the environment.

- With a full charge, LORUS LUMIBRITE watches glow in the dark hours longer than conventional luminous watches of this type. If exposed to a light of more than 500 lux (i.e., the brightness of a typical office) for approximately 10 minutes, or direct sunlight for 2 minutes, they will glow for hours.
- Since LORUS LUMIBRITE watches emit the light they store, the brightness will decrease gradually over time. The length of time they will glow may also differ slightly depending on such factors as the brightness of and distance from the light source used to charge the watch.

■ BATTERY CHANGE

The battery SEIKO SR927SW, Maxell SR927SW, SONY SR927SW or EVEREADY 395, which powers your watch, should last approximately 3 years. However, because it is inserted at the factory, the actual life of the battery once in your possession may be less than the specified period.

Be sure to replace the battery to prevent any possible malfunction as soon as it runs down. To replace the battery, we recommend taking the watch to a local watch repair shop.

Note:

1. If the stopwatch is used for more than 3 hours a day, the battery life may be less than the specified period.
2. After the battery is replaced with a new one, set the time/calendar and adjust the stopwatch hand position.

Battery life indicator

- When the battery nears its end, the small second hand moves at two-second intervals instead of normal one-second intervals. In that case, have the battery replaced with a new one as soon as possible.
- The watch remains accurate, however, while the small second hand is moving at two-second intervals.

■ CARE OF YOUR LORUS WATCH

• BATTERY

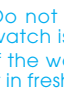

CAUTION

Do not expose the old battery to fire or recharge it. Keep it at a place beyond the reach of children. If a child swallows it, consult a doctor immediately.

• WATER RESISTANT

Condition of use / Indication on the dial/case back	Accidental contact with water, such as splashes and rain	Swimming and taking a shower	Skin diving	Scuba diving
No Indication	NO	NO	NO	NO
WATER RESISTANT	YES	NO	NO	NO
WATER RESISTANT (50M/5 BAR)	YES	YES	NO	NO
WATER RESISTANT (100M/10 BAR or above)	YES	YES	YES	NO

* If your watch is 200 M/20 BAR, 100 M/10 BAR or 50 M/5 BAR water resistant, it is so indicated on the dial/case back.

- Do not press or turn the crown when the watch is wet.
- If the watch is exposed to salt water, rinse it in fresh water and then wipe it thoroughly dry.

Caution:

Leather straps are not water resistant except so indicated, even if the watch head is water resistant.

• ALLERGIC REACTION

Because the case and band touch the skin directly, it is important to clean them regularly. If not, shirt sleeves may be stained and those with delicate skin may develop a rash. Please wear the watch with some play to avoid any possible allergic reaction. If you develop a rash on your wrist, stop wearing and consult a physician.

• MAGNETISM

Your watch will be adversely affected by strong magnetism. Keep it away from close contact with magnetic objects.

• SHOCKS AND VIBRATIONS

Your watch may be worn for normal sports activities, However, be careful not to drop it or hit it on hard surfaces.

• TEMPERATURE

Your watch is preadjusted so that constant accuracy may be insured at normal temperature.

■ SERVICE

When your LORUS watch requires repair or servicing, please see the enclosed WARRANTY/GUARANTEE.